

THE INFORMATION CONTAINED IN THIS DRAWING IS THE SOLE PROPERTY OF L-COM, INC. ANY REPRODUCTION IN PART OR WHOLE WITHOUT THE WRITTEN PERMISSION OF L-COM, INC. IS PROHIBITED.

REVISIONS			
REV	DESCRIPTION	DATE	APPROVED
A	INITIAL RELEASE	6/28/13	D.GRIFFIN
-	-	-	-
-	-	-	-
-	-	-	-

DESCRIPTION	MATERIAL	FINISH
BODY	BRASS	SILVER
SHELL	BRASS	NICKEL
INSULATOR	PTFE	---
CENTER PIN	BRASS	SILVER
O-RING	RUBBER	---

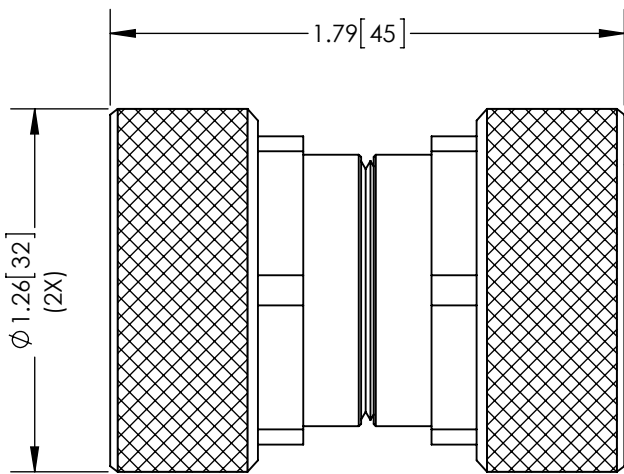
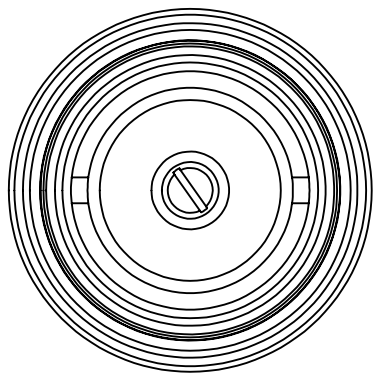
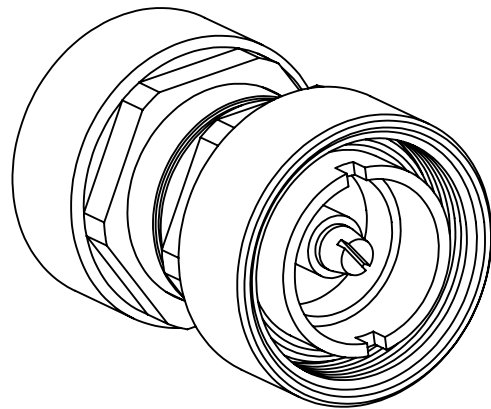

M29xP1.5-2B  
(2X)

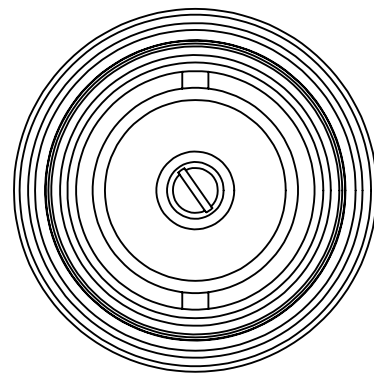

#### NOTES:

##### ELECTRICAL:

IMPEDANCE: 50OHM

FREQUENCY RANGE: DC~6 GHz

INSERTION LOSS: .2 dB MAX.

WORKING VOLTAGE: 2700 VRMS MAX.

DIELECTRIC WITHSTANDING VOLTAGE: 4000 VRMS MIN.

##### PACKAGING:

COMPONENT SHALL BE INDIVIDUALLY PACKAGED IN ACCORDANCE WITH L-COM SPECIFICATION PKG-00012

#### REGULATORY COMPLIANCE:

RoHS, CE

UNLESS OTHERWISE SPECIFIED, DIMENSIONS ARE IN INCHES [mm]  DIMENSIONAL TOLERANCES: .X = ±.1 .XX = ±.01 .XXX = ±.005  ANGULAR TOLERANCES: ALL = ± 1°  PROJECTION 	APPROVALS	DATE	 45 BEECHWOOD DRIVE NORTH ANDOVER, MA 01845	
	DRAWN BY B.PUCHASKI	06/27/13		
	CHECKED BY K.BURGNER	06/27/13	CATEGORY COAXIAL	
	APPROVED BY P.PESA	06/27/13	PRODUCT DESCRIPTION 7/16 DIN MALE TO 7/16 DIN MALE ADAPTOR	
CONFIGURATION DETAILS OF UNDIMENSIONED FEATURES MAY VARY		SIZE <b>A</b>	FSCM NO. <b>43321</b>	DWG. NO. AXA-DMDM
COLOR VARIATIONS MAY OCCUR		SCALE: NONE	CAD FILE: AXA-DMDM.SLDDRW	REV. <b>A</b>
		SHEET 1 OF 1		